

**2017 FLORIDA STATE**  
**NRA State Precision Pistol Championship**  
**.22 Caliber Only Aggregate Match**  
**NRA Distinguished Revolver Match**  
**with CMP Service Pistol EIC Match and CMP .22 RIMFIRE EIC Pistol Match**  
Sponsored by The Florida Sports Shooting Association  
&  
Hosted by Gateway Rifle and Pistol Club

**Date:** October 14 and 15, 2017

**Location:** Gateway Rifle and Pistol Club, 9301 Zambito Road, Jacksonville, FL 32210

**Eligibility:** Open to any individual. However, The State Champion must be a Florida State resident and current Florida Sport Shooting Association (FSSA) member. Refer to NRA Precision Pistol rules for further guidance.

**NRA Membership:** NRA membership is encouraged, but not required to compete. In order to enter scores of competitors in the computer classification system, all competitors who are NRA members must provide their NRA member ID number on their registration form. Non-NRA members who have a classification number must put that number on their entry card.

**State Association Membership:** FSSA membership or other state association membership is strongly encouraged to compete in this match. Information on FSSA membership may be obtained at: <https://fssaf.wildapricot.org/>. Membership applications will be available at the match.

**Rules:** Current NRA Precision Pistol Rules will govern for the Regional Championship, .22 Caliber Only Aggregate Match and NRA Distinguished Revolver Match. NRA Pistol rules are available on-line at: <http://compete.nra.org/documents/pdf/compete/RuleBooks/Pistol/pistol-book.pdf>. Current Civilian Marksmanship Program rules will govern for the CMP Service Pistol EIC Match and CMP .22 Rimfire EIC Pistol Match. CMP rules are available on-line at: <http://thecmp.org/wp-content/uploads/Rulebook.pdf>. CMP affidavits will be processed during check in.

**Classification:** The NRA classification system will be used in all matches. Individuals who have not been classified will fire in the Master Class. Rule 19.6 (Assigned Classification) may be used.

**Classes:** A minimum of 4 competitors (or 4 teams) will constitute a class. If less than 4 competitors (or 4 teams), those competitors will compete in the next higher class. If there are less than 4 High Masters in a category/class, they will compete for open awards only.

**Categories:** Four or more shooters are required to make a category as defined by NRA rules.

**Divisions:** Open and Metallic Divisions will be recognized. A minimum of 4 competitors will constitute a Division within a class. If there are less than 4 competitors within a Division, those competitors will compete in the next higher Division. (Metallic > Open). Scores within the Divisions for all shooters will count toward NRA Classification.

**.22 Caliber Only Aggregate Match:** Shooters wishing to fire the .22 Caliber Only Aggregate Match are welcome to register, but will not be eligible for the State Champion award. See NRA rule 22.

**Challenges:** A challenge fee of \$3.00 will be charged for each challenge made. See NRA rule 16 for challenge and protest procedure.

**Fees:**

Entry Fee for Registered 2700	\$85 (Includes NRA & FSSA fees)
Entry Fee for individual 900	\$30
Entry Fee for Junior (NRA rule 2.3)	\$40
Entry Fee for individual 900 (Junior)	\$15
Late Entry Fee (after October 1)	\$10
Team Matches (.22, CF & 45)	\$10 (2/4 person "Paper" team)
NRA Distinguished Revolver Match	\$5 (if shooting any/all of NRA 2700 match)
NRA Distinguished Revolver Match	\$10 (if no NRA match included)
CMP Service Pistol EIC Match	\$15
CMP .22 Rimfire Pistol EIC Match	\$15
Second Amendment Freedom Match	\$5

**Squadding:** All matches will be squadded. Squadding assignments for individual matches will be issued from the Statistical Office and will be available on Friday, October 13 from 1:00 to 6:30 PM. Competitors must pick up competitors packets prior to shooting. FSSA membership cards and NRA classification cards must be exhibited before issue of squadding tickets. A competitor who fails to obtain his squadding tickets or who fails to present himself at the proper firing point when his relay is called may lose his right to compete in that event. "Paper" teams will be fired during the National Match Course each match (.22, CF & 45).

**Time of Firing:** Firing will commence at 8:00 AM each day. Based on the number of competitors, the Match Director will adjust the starting time to 9:00 AM on Sunday if only one relay is needed.

**Entries:** Entries in individual events will be made by using the enclosed Statistical Office Record Form accompanied by check or money order. Please make checks payable to **Gateway Rifle and Pistol Club**. Be sure to indicate your correct NRA classification, division, category and NRA membership ID number. Please include your FSSA or state association number. Confirmation via regular mail will be made only if the competitor encloses a self-addressed, stamped envelope or postcard. Mail the entry form with correct fee to:

Ted Carter  
Attn: Florida State Championship  
4412 Hood Road  
Jacksonville, FL 32257

Competitors may scan and return their entry form via e-mail to **cdrocoach@reagan.com**,  
Subject line: FL State Championship Match Entry.

NOTE: If you do not get an e-mail response back within several days of sending your registration, you may contact the Match Director at: 904-880-1715.

**Entries Close:** Individual match entries close at 4:00 PM on October 13th. Team match entries close at 8:00 AM of the day the team matches are to be fired.

**Entries Limited:** Entries are limited to 50 competitors. Preference will be given Florida State residents and to competitors who fire the full schedule.

**Post Entries:** Entries received after 1 October will be accepted up to the stated limit of the range, provided such entries will not require special relays and must include a \$10 late fee.

**Awards:** The State Championship winner will receive a trophy plaque provided by FSSA. NRA award points will be given for open and class winners in Matches 1-18 and class winners in Match 19. Second and third place class awards will be given for 8 and 12 competitors in class respectively. Category and Division winners will also receive awards. Achievement Pins/Medals for the CMP Service Pistol EIC Match and CMP .22 Rimfire EIC Pistol Match will be provided by the Civilian Marksmanship Program. All other awards are provided by FSSA & Gateway Rifle and Pistol Club with 50% minimum of Regional fees (less NRA & FSSA registration fees) being awarded back to the competitors.

**Match Schedule:** For Saturday, relay start times are as follows:

8:00 AM	Relay 1
10:00 AM	Relay 2
1:00 PM	CMP .22 Rimfire Pistol EIC
TBD	NRA Distinguished Revolver
TBD	CMP Service Pistol EIC

For Sunday, relay start times are as follows:

8:00 AM	Relay 1
10:00 AM	Relay 2
12:00 PM	Relay 1
2:00 PM	Relay 2
TBD	Second Amendment Freedom Match
TBD	Award Ceremony (conducted as soon as possible after final relay and upon receipt & recording of all scores by the statistical officer)

**Saturday, October 14, 2017** Match 1 - .22 Caliber Slow Fire  
Match 2 - .22 Caliber National Match Course  
Match 3 - .22 Caliber Timed Fire  
Match 4 - .22 Caliber Rapid Fire

CMP .22 Rimfire EIC Pistol Match (max 2 relays as required)  
NRA Distinguished Revolver Match (max 2 relays as required)  
CMP Service Pistol EIC Match (max 2 relays as required)

**Sunday, October 15, 2017** Match 7 - Center Fire Slow Fire  
Match 8 - Center Fire National Match Course  
Match 9 - Center Fire Timed Fire  
Match 10 - Center Fire Rapid Fire

- Match 13 - .45 cal Slow Fire
- Match 14 - .45 cal National Match Course
- Match 15 - .45 cal Timed Fire
- Match 16 - .45 cal Rapid Fire

Second Amendment Freedom Match (limited 2 relays)  
 See page 5 for match details.

Note: Two (2) or four (4) person Team Matches "Paper Teams" will be fired during the National Match Course of the 22, CF & 45 events. The CMP .22 Rimfire EIC Pistol Match, NRA Distinguished Revolver and CMP Service Pistol EIC Match will be fired in up to two (2) relays of up to 25 competitors each.

**Aggregate Matches:**

- Match 5 - Regional .22 Caliber Championship, aggregate of Matches 1, 2, 3, and 4
- Match 11 - Regional Center Fire Championship, aggregate of Matches 7, 8, 9, and 10
- Match 17 - Regional .45 Caliber Championship, aggregate of Matches 13, 14, 15, and 16
- Match 19 - Regional Championship, aggregate of Matches 5, 11, and 17

**Practice:** The range will be open to competitors wishing to practice on Friday October 13th, from 1:00-5:30 PM. Competitors who wish to practice must pick up their competitor packet prior to practice.

**Directions to Range:** From I-295, take 103<sup>rd</sup> Street West 3 miles to Old Middleburg Road (Kangaroo Express/Mobil station on right); turn right (North) and proceed 1 mile to No Road Street at stop light; turn left (West), proceeding 1.2 miles to Zambito Road: turn right (North), proceed 0.5 miles to club driveway, on right. Drive up to the entry cross bar. It will open automatically. Turn right and follow the road around to the 25/50 yard range.

**Lodging:** There are a number of moderately priced motels within 5-10 miles of the range. Note: Gateway Rifle and Pistol Club no longer offers on site RV hook ups. Contact the Match Director for details.

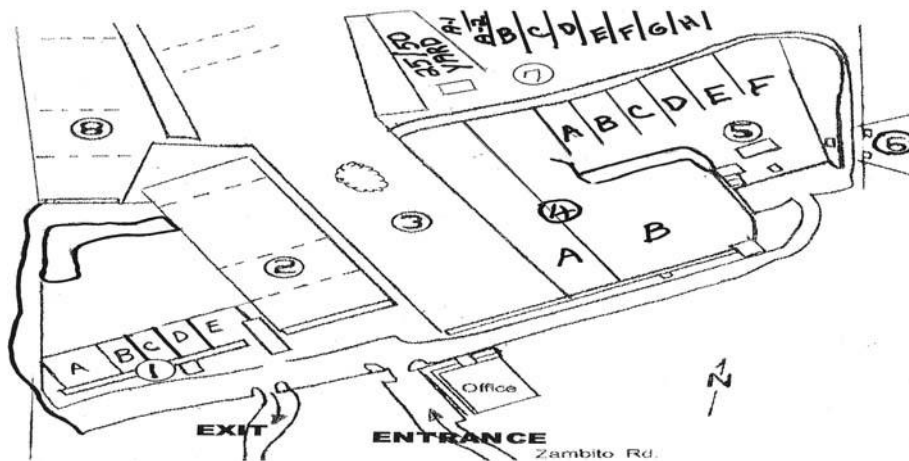

## **\*\* ALMOST NEW FOR 2017\*\***

**The Second Amendment Freedom Match:** Sunday, October 15th, this is a special match following the conclusion of the .45 Match, for competitors wishing to participate. This is a standalone match and has no impact on the state championship.

The Second Amendment Freedom Match (SAFM) is a National Match Course (30 rounds) fired at 25 yards on the B-8 target for slow, timed and rapid fire. Slow fire time limit will be reduced to 5 minutes for 10 rounds. Competitors will be allowed to use two hands as they desire. Timed and rapid fire will begin with the loaded pistol pointed down at a 45-degree angle, without touching the bench. There will be no alibi strings except for a range malfunction.

The authorized pistol is intended to be an "**out of the box**" **non-match conditioned firearm** similar to your personal defense / home defense firearm. The Match Director will be the final authority on authorized pistols.

Ammunition is any safe, non magnum, load for your particular firearm.

Cost for the SAFM is \$5.00 with 50% of the registration fees going to support a state or club junior program to be designated, and the remaining 50% being divided among randomly selected competitors(s). The number of entries will determine the number of randomly selected competitors eligible for cash awards.

***This match is designed to be a fun match.***

# FLORIDA STATE CHAMPIONSHIP - STATISTICAL OFFICE RECORD

---

(Please Print)      Last Name                                      First Name                                      Middle Initial

---

Street Address

---

City                                      State                                      Zip Code

---

Home/ Cell Phone / Work Phone /                                      E-mail Address

---

Date of Birth (MM/DD/YYYY)                                      NRA ID #                                      FSSA Mbr # / State Mbr #

**CATEGORIES (circle all that apply) (NRA rule 2. Eligibility and Categories of Competitors)**

Service    Police    Civilian    Veteran    Senior    Grand Senior    Woman    Junior

**CLASSIFICATION (circle one) (NRA rule 19. National Pistol Classification)**

Unclassified    High Master    Master    Expert    Sharpshooter    Marksman

**DIVISION (circle one) (NRA rule 3. Equipment and Ammunition)**

.22 Caliber Championship:    Open    Metallic

Center Fire Championship:    Open    Metallic

.45 Caliber Championship:    Open    Metallic

State Aggregate Championship:    Determined by the highest Division an individual competes in, in the order listed: Open and Metallic Division(s)

Note: Competitor's classification in the highest Division will be used

**.22 Caliber Only Aggregate (circle) (NRA rule 22.)            Open**

**RELAY PREFERENCE (circle one)    First Relay    Second Relay**

Note: Competitors requesting Second relay may be squadded on First relay if there are insufficient competitors to fill First relay.

# FLORIDA STATE CHAMPIONSHIP - STATISTICAL OFFICE RECORD

## REGISTRATION FEES

	Before October 1, 2017	After October 1, 2017
2700 State Entry:	\$85 _____	\$95 _____
900 State Entry: Circle all that apply (22 CF 45)	\$30 _____	\$40 _____
2700 State Entry: Juniors	\$40 _____	\$50 _____
900 State Entry (Junior): Circle all that apply (22 CF 45)	\$15 _____	\$25 _____
Team Entry:	\$10 _____	\$10 _____
NRA Distinguished Revolver Match (if firing any portion of the NRA 2700)	\$5 _____	\$5 _____
NRA Distinguished Revolver Match (If NOT firing any portion of the NRA 2700)	\$10 _____	\$10 _____
CMP Service Pistol EIC Match:	\$15 _____	\$15 _____
CMP .22 Rimfire EIC Pistol Match:	\$15 _____	\$15 _____
Second Amendment Freedom Match	\$5 _____	\$5 _____
TOTAL:	_____	_____

# FLORIDA STATE CHAMPIONSHIP MATCH

## TEAM MATCH ENTRY FORM

There will be no individual fired team matches for this championship. "Paper" Teams are encouraged from various clubs throughout the state and other organizations. Team matches will be fired during the National Match Course of the .22, CF and .45 matches.

Teams may consist of (2) two or (4) four firing members. Team classification will be determined by the classification of the firing members in accordance with NRA rule 19.12.

Refer to NRA rules 2.10-2.20 for team composition.

For award purposes, all teams will compete by NRA classification . Awards by classification will be issued to the winner of the grand aggregate. Four teams are required to form a class.

**Entries will be accepted only with full payment for the entire team.**

TEAM MEMBER	CLASS
1. _____	_____
2. _____	_____
3. _____	_____
4. _____	_____

TEAM CATEGORY (circle one)    Service    Police    Civilian

Team Captain: \_\_\_\_\_ Team Name: \_\_\_\_\_

TEAM CLASSIFICATION (circle one)    HM    MA    EX    SS    MK

REGISTRATION FEE \$10    AMOUNT PAID: \_\_\_\_\_